



ACREAGE: 36.7 | YEAR ACQUIRED: 2003

Glennwood contains a circumneutral bog, one of only 15 in Indiana. The bog once was a lake, but it is now nearly filled with a springy mat of mosses, ferns and sedges resting on a bed of peat. Poison sumac, pin oak, willow and red maple surround the bog area. In the forest around the bog grow Canadian mayflower, shiny club moss and sarsaparilla, as well as cinnamon, crested shield and royal ferns. The preserve is noted for spectacular fall color.



Nodding Lady's Tresses

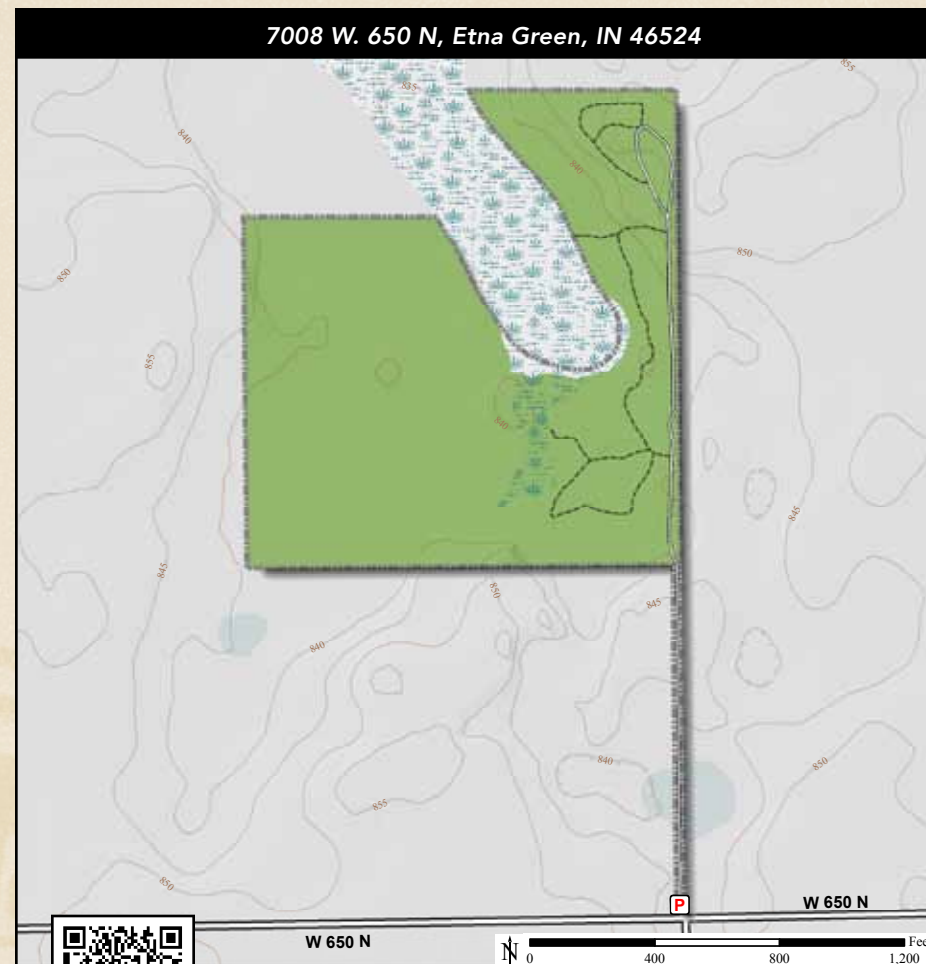

DIRECTIONS:

From Etna Green take US 30 east 3.75 miles to 700 W and turn left (north). Travel 4.2 miles to its end at 650 N. The preserve is straight ahead on the north side of 650 N.

