



ACREAGE: 7.9 | YEAR ACQUIRED: 1974

Fox Fire Woods is high, well-drained land producing a woodland where the dominant trees are oak and hickory. Along the west side are wild plum and hawthorn trees. The Fox Fire name is from a fungus that grows on decaying vegetation on the woodland floor and glows eerily in the dark.



Honeybees

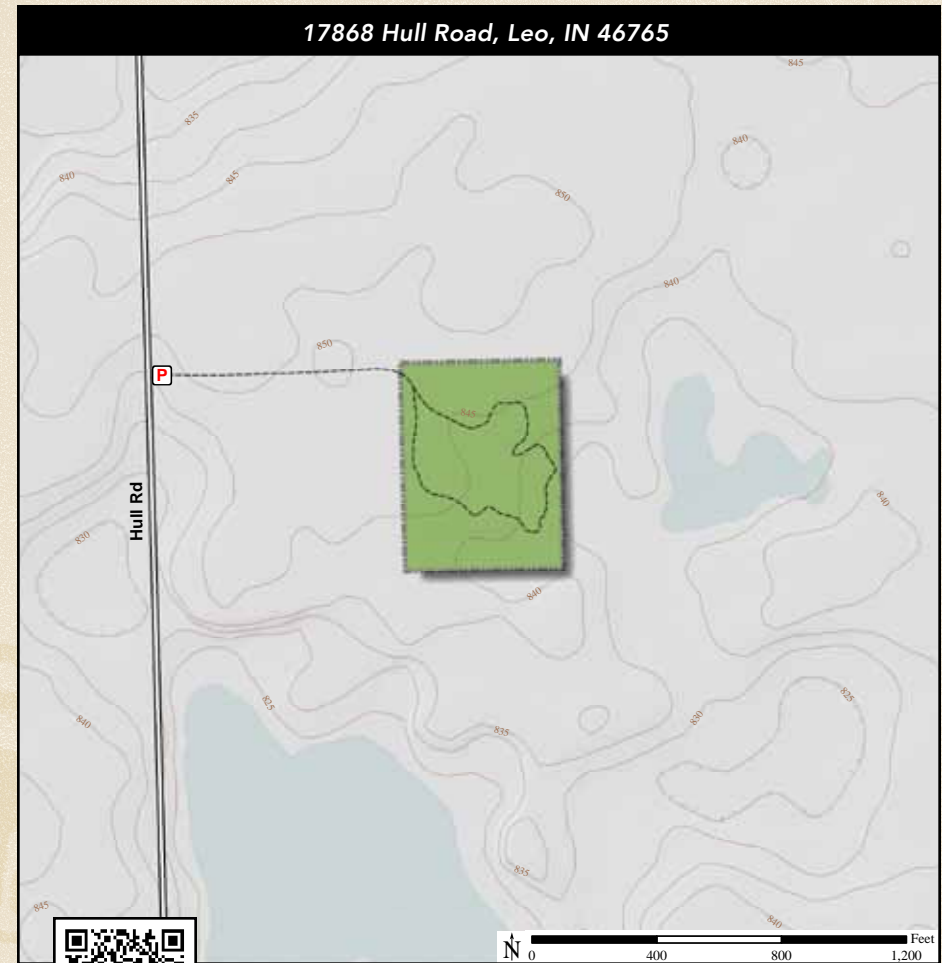

DIRECTIONS:

From Leo at SR 1 and Hosler Rd., go west on Hosler Rd. 0.4 miles to Amstutz Rd. and turn right (north). Travel 1.0 miles to Schlatter Rd. and turn left (west). Travel 0.5 miles to Painter Rd. and turn right (north). Travel 0.5 miles to Hollopeter Rd. and turn left (west). Travel 0.5 miles to Hull Rd. and turn right (north). Travel 0.5 miles to the preserve on the right.

