



ACREAGE: 46.8 | YEAR ACQUIRED: 2007

Sap was once harvested from the maples here and boiled down into syrup. This beech/maple woods also includes tulip, sycamore, black cherry and blue ash – an unusual tree in the area. The grinding of glaciers over the area left several depressions that are now small ponds, the largest approximately an acre and a half. Flowering trillium blooms abundantly here in spring, and tall-grass prairie plants have been established in a field.



Black-eyed Susan

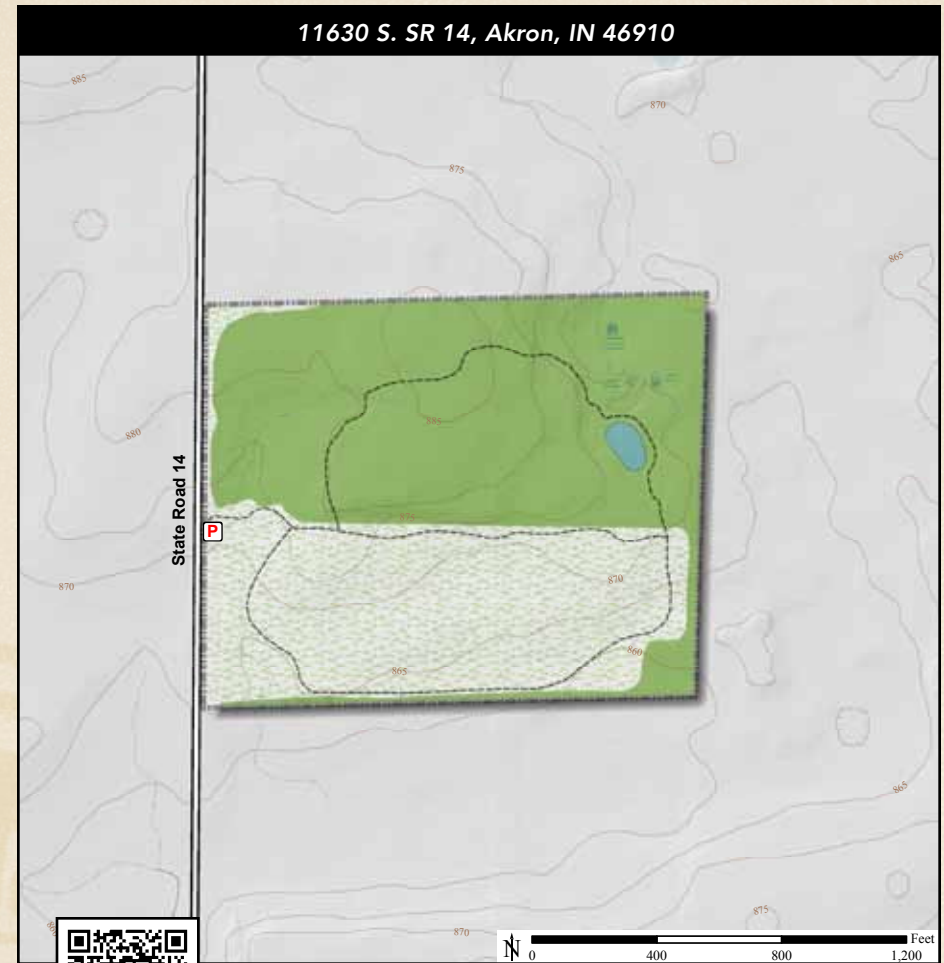

DIRECTIONS:

From Akron take SR 114 east 0.5 miles to SR 14 (1000 W) and turn left (north). Travel 1.6 miles to the preserve on the right.

