

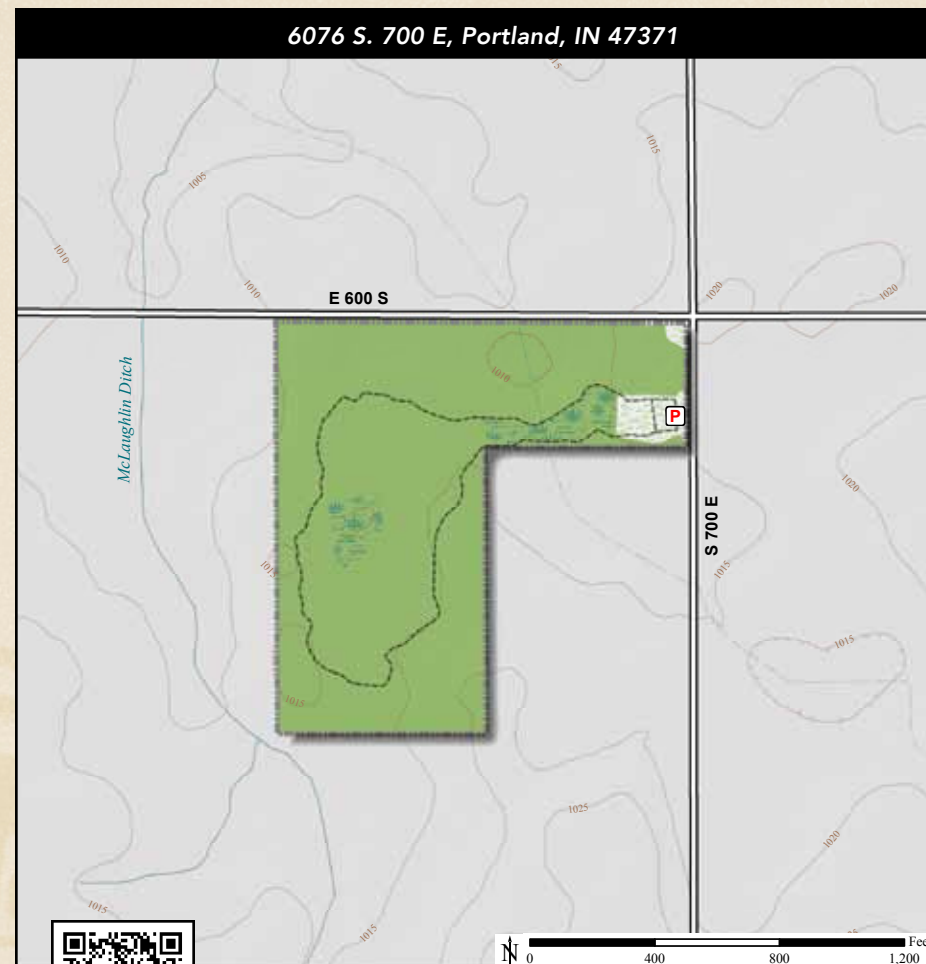

ACREAGE: 27.3 | YEAR ACQUIRED: 1994

From 1854 to 1975, students attended school at this site, first in a log cabin, then in a “modern” school built in 1923. Today, a boulder with an inscription commemorates the school, and sugar maple, ash, hickory and oak trees grow where students once played. There’s an understory of smaller trees, shrubs and wildflowers. Slowly the trees are maturing, and through natural succession, the other vegetation is changing.



DIRECTIONS:

From Portland at US 27 and Main St., take US 27 south 0.1 miles to SR 26 (Water St.) and turn left (east). Travel 7.0 miles to 700 E and turn right (south). Travel 5.6 miles to the preserve on the right, just past 600 S.

