



ACREAGE: 135.2 | YEAR ACQUIRED: 1996, 1997

 The centerpiece of this preserve is the Fawn River, which winds back and forth across the Michigan/Indiana line. Woods along the river are second-growth, with small pockets of older trees where there has been no clearing. This is a floodplain forest with trees and other plants that survive periodic flooding.



Ice Formation

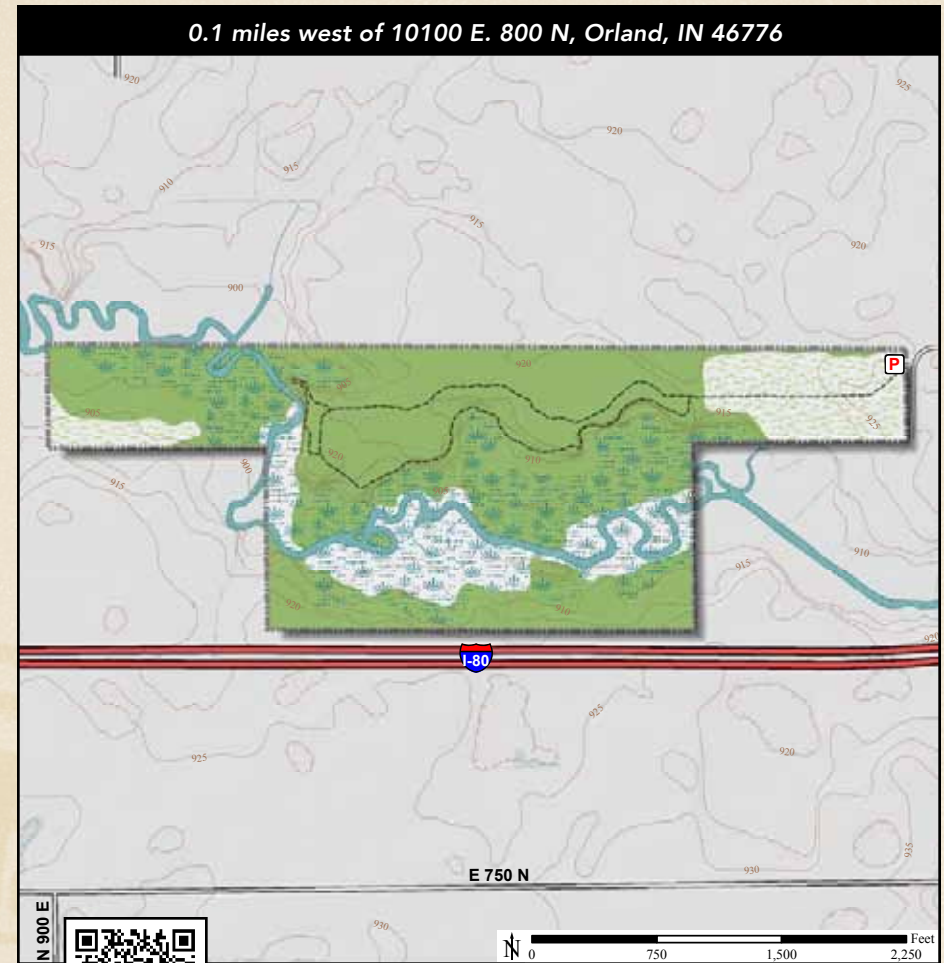

### DIRECTIONS:

From LaGrange at US 20 and SR 9, take US 20 east for 12.5 miles to SR 327. Turn left (north) and travel 8.0 miles, through Orland, to the state line (Greenfield Rd.). Turn left (west) and travel 3.0 miles to where Greenfield Rd. turns north. At this junction there is a lane that continues due west approximately 800' to the parking area. Parking area is 0.1 miles west of 10100 E. 800 N, Orland, IN 46776.

