



ACREAGE: 132.9 | YEAR ACQUIRED: 2001, 2004, 2006



*This forested highland cut by ravines has a long list of trees: beech, maple, oak, hickory, cherry and many more. There are many species of birds here, including the red-tailed hawk, great horned owl, blue jay, cardinal and red-eyed vireo. Plus, there are downy, hairy and red-bellied woodpeckers. You'll also find an abundance of wildflowers: blue-eyed Mary, Jack-in-the-pulpit, spring beauty and firepink, as well as blue, white and yellow violets and many others.*



Blue-eyed Mary

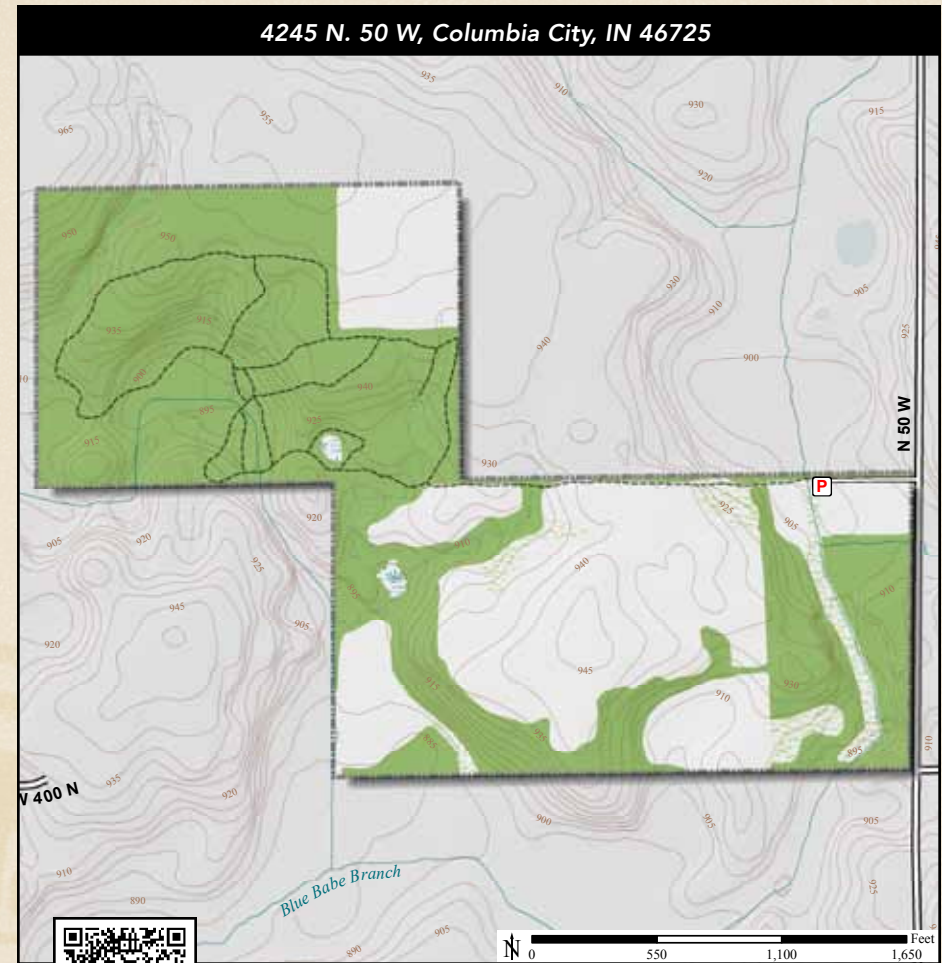

**DIRECTIONS:**

From Columbia City take SR 109 (Line St.) north, crossing US 30, 4.5 miles to 400 N and turn left (west). Travel 0.5 miles to 50 W and turn right (north). Travel 0.25 miles to the preserve on the left.

