

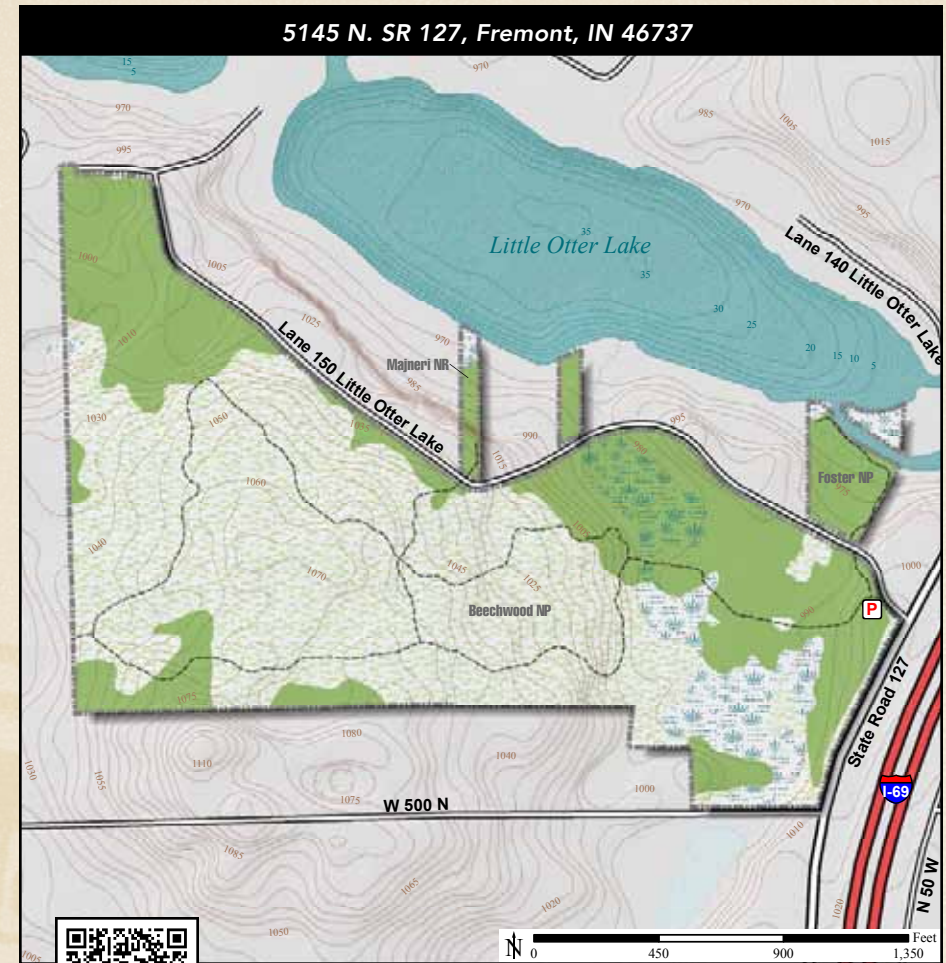

ACREAGE: 89.8 | YEAR ACQUIRED: 1964, 1971, 1973, 2000



Beechwood is adjacent to Pokagon State Park and has a mixture of habitats, including a beech/maple forest; yellow birch, red maple, red elm and blue beech trees; rolling meadows; thickets with dogwood, poison sumac, elderberry and spicebush; and a fen. Birds and wildflowers are as varied as the cover.



Swift Long-winged Skimmer on Cutleaf Coneflower

DIRECTIONS:

From Fremont take SR 120 west 3.5 miles, crossing over I-69, to SR 127 and turn left (south). Travel 0.9 miles to the preserve on the right, at Lane 150.

